



80, Hawley Road, Dartford DA1 1PA
Guide Price £425,000



Guide Price £425,000-£450,000 Park Estates are pleased to present this well-maintained and extended three-bedroom terraced home, ideally positioned for a range of highly regarded local schools including Oakfield Primary, Wilmington Grammar Schools, Wilmington Academy and Dartford Grammar Schools, as well as nearby shops and excellent transport links. An ideal choice for families, the property offers deceptively spacious accommodation throughout. The ground floor comprises an entrance porch, welcoming entrance hall, modern ground-floor shower room, a generous reception room and a contemporary fitted kitchen/diner.

To the first floor, there is a family bathroom and three well-proportioned bedrooms.

Externally, the property features both front and rear gardens, with the rear benefitting from an outbuilding, detached garage and off-street parking. Additional benefits include double glazing, gas central heating and the advantage of no forward chain.

Early viewing is strongly recommended to appreciate the space and convenience this home offers.

Local Authority: {prop_LA_county}

Council Tax Band: {council_tax_band}



01322 553322

60-62 High Street, Bexley, Kent, DA5 1AH

bexley@parkestates.co.uk
www.parkestates.co.uk

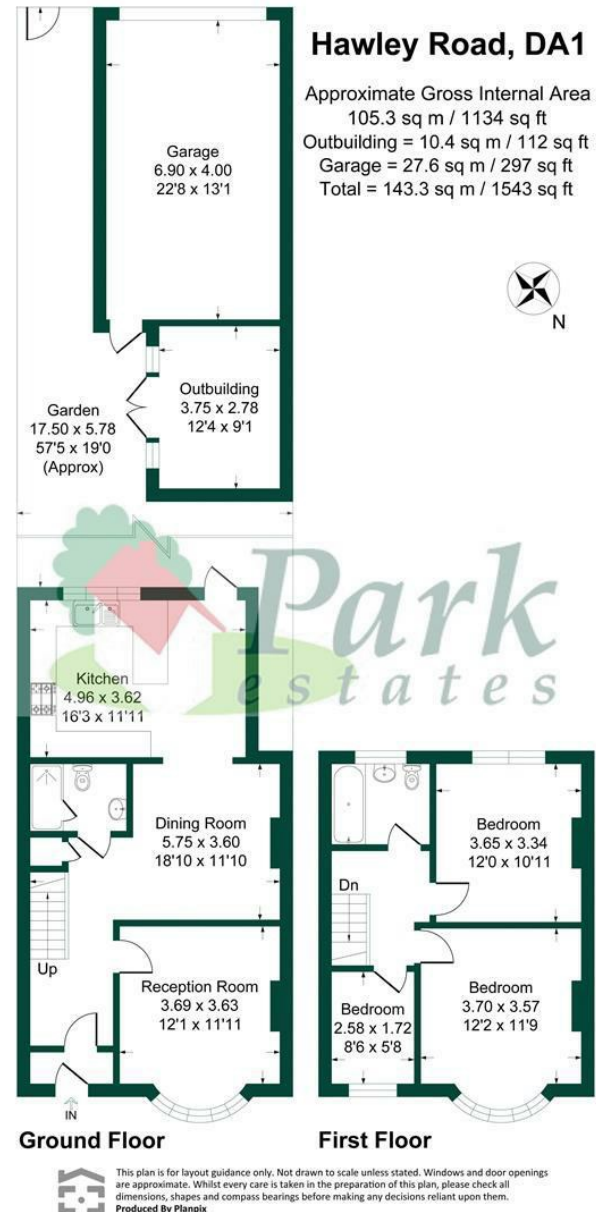

Every care has been taken with the preparation of details, but accuracy is in no way guaranteed. These particulars do not constitute a contract and are issued and accepted on the express understanding that all negotiations will be conducted through Park Estates. The seller does not make or give, nor do we or our employees have any authority to give a representation or warranty in relation to the property. Please contact this office before viewing the property. If there is any point which is of particular importance to you, we will be pleased to check the information for you and confirm that the property remains available. This is particularly important if you are contemplating travelling some distance to view the property. We would strongly recommend that all the information that we provide about the property is verified by yourself on inspection and also by your conveyancer, especially where statements have been made by us to the effect that the information provided by us has not been verified.